

USER GUIDE

This step-by-step guide will help you navigate the initial set-up stages & ensure you get the best out of Dazzle+ & Lustre and leave your glasses sparkling clean.

STEP 1

Remove any glasses, chemicals or other such items that are in your glasswash.

Ensure the wash cycle is set to the temperature of 60°C.

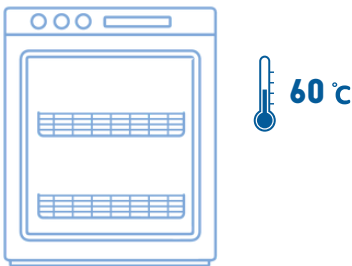

STEP 2

Add Dazzle+ to your detergent tube - do not add any rinse aid.

Dazzle+ is designed to lift and remove grime, dirt & soil. The added renovating compounds allow greater cleaning efficacy.

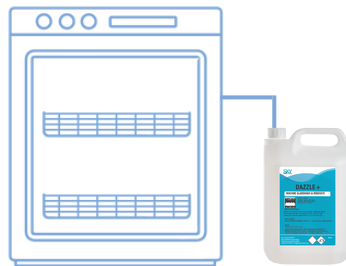

STEP 3

Run wash cycle.

Recommendations:
Run the machine for 1-2 cycles This will wash away any residual chemicals and debris from your previous wash cycles.

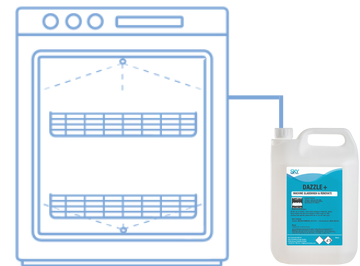

STEP 4

Add the rinse aid, Lustre, to the rinse tube, add glasses to the machine and run a test wash cycle.

Lustre rinse aid is designed to wash off any residual chemicals off the glasses, ensuring that your glasses are clean and the quality of your beers are unaffected

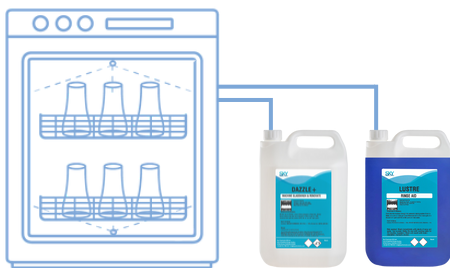

STEP 5

After the test cycle check your glasses for any stains or marks and adjust the amount of Dazzle+ & Lustre in the machine accordingly.

Now that your glasses are squeaky clean and your glasswash machine is ready for use!



COMMON ISSUES & HOW TO RESOLVE THEM

<p>WHITE MARKS ON GLASSES ?</p>	<p>May be caused by a build up of limescale or too much Dazzle+ being fed into the machine. Use our glasswash machine cleaner Supreme to properly clean your machine of limescale, and reduce the amount of Dazzle+ being fed into your machines</p>
<p>NO BEER HEAD OR THE BEER IS FAT ?</p>	<p>Perhaps too much Dazzle+ or too little Lustre is being fed into the machine, reduce the amount of Dazzle+ being fed or increase the amount of Lustre being fed</p>
<p>GLASSES ARE COVERED IN SOIL ?</p>	<p>Soil and dirt can be embedded in your glasswash machine, run a few more wash cycles with Dazzle+ alone, to help clean the machine</p>